

# National Honor Society Membership Application

## Etowah High School Chapter – Fall 2018



### Directions (please follow carefully):

1. Print out this form and complete all sections *legibly in blue or black ink*.
2. Once your application is complete, **scan the completed application along as ONE pdf file**. If you do not know how to do this or have any difficulty accessing a scanner, please visit the media center and use the attached instructions. You may also use the free app called Turbo Scanner.
3. Email the scanned pdf file (which should contain your membership application and personal statement) to Margo Kemmerer at [margo.kemmerer@cherokee.k12.ga.us](mailto:margo.kemmerer@cherokee.k12.ga.us) no later than **Thursday, September 6**. You will receive a confirmation email when your application is received. Turn the original hard copy application and letters in to Margo Kemmerer in room 209 at Etowah East by September 6 as well to ensure that your electronic application was received. You will be notified whether your membership has been accepted or not by the end of September.

### Please note:

- **Do not be modest, as criteria for acceptance is stringent.** All of the information that you provide will be used by the Faculty Council to assist with the fair consideration of your candidacy during the selection process.
- **Completion and submission of this form does not guarantee selection.** Completed applications must be submitted on or before **Thursday, September 6**. No late applications will be accepted.

The criteria that will be used by the Faculty Council to determine National Honor Society Selection are:

1. **Scholarship:** Students who have a 94 weighted cumulative average for all courses receiving high school credit after two years of high school are eligible for consideration on the basis of service, leadership, and character.
2. **Service:** This quality is defined through the voluntary contributions made by a student to the school or community, done without compensation and with a positive, courteous, and enthusiastic spirit.
3. **Leadership:** Student leaders are those who are resourceful, good problem solvers, promoters of school activities, idea-contributors, dependable, and persons who exemplify positive attitudes about life. Leadership experiences can be drawn from school or community activities while working with or for others.
4. **Character:** The student of good character upholds principles of morality and ethics, is cooperative, demonstrates high standards of honesty and reliability, shows courtesy, concern, and respect for others, and generally maintains a good and clean lifestyle.

### I. Administrative Information

Name \_\_\_\_\_ Current Grade Level : 12      GPA: \_\_\_\_\_

Other high schools you have attended: (include years) \_\_\_\_\_

### II. Signatures

*I understand that completing and submitting this application puts my name in consideration for membership but does not guarantee an invitation to become a member of the National Honor Society. I attest that the information presented here is complete and accurate to the best of my knowledge. If selected, I agree to abide by the standards and guidelines of the Etowah NHS chapter and fulfill all of my membership obligations to the best of my ability including regular attendance at monthly meetings and completing required service hours.*

Student Signature \_\_\_\_\_

Date \_\_\_\_\_

Student Email \_\_\_\_\_

*I have read the information provided by my son/daughter on this form and can verify that it is true, accurate, and complete.*

Parent Signature \_\_\_\_\_

Date \_\_\_\_\_

Parent phone number(s) \_\_\_\_\_

Parent Email \_\_\_\_\_

**III. Co-curricular Activities**

List all clubs, organizations, teams, musical groups, or other groups you are a member of at Etowah High School and/or in the community. Include any major accomplishments or leadership roles in each along with the name and signature of an adult supervisor who can verify your participation.

Name of Club, Group or Activity	Years Participated In			Briefly describe your responsibilities, accomplishments, and leadership roles	Adult Supervisor Name and Signature
	9	10	11		

**IV. Leadership Positions**

List all elected or appointed leadership positions held in school, community, or work activities. Only those positions in which you were directly responsible for directing or motivating others should be included. *For example, elected class or club officer, committee chairperson, team captain, newspaper editor, work area manager, or community leader.* Be sure to include the name and signature of the adult supervisor that can verify your leadership role.

Leadership Position in Name of Activity or Organization	Years Participated In			Briefly describe your responsibilities, accomplishments, and leadership roles	Adult Supervisor Name and Signature
	9	10	11		

**V. Community Service**

List all community activities in which you have **performed service** and note any special accomplishments in each. These should be any activities **outside** of school in which you performed service for the betterment of your community, **not as a requirement for a club/sport and not one in which you have been financially compensated**. *Examples may include church service groups, boy or girl scouts, volunteer groups, community events or fundraisers.* Be sure to include the name and signature of the adult supervisor that can verify your participation. **\*Activities without a verification signature will be not be considered.**

Community Activity	Years Participated In			Approximate Number of Hours Worked	Briefly describe your responsibilities and accomplishments participating in this activity	Adult Supervisor Name and Signature
	9	10	11			

**VI. Recognitions and Awards**

List any honors or recognitions that you have received during your high school years up to this point in time.

Recognition or Award	Year Awarded			Name of Group or Activity the Recognition or Award was sponsored by
	9	10	11	

## VII. Personal Statement

Choose **ONE** of the prompts below to respond to with a well-developed paragraph style essay. Do NOT just regurgitate your application! Please use spell check and/or have a parent proofread your essay. Your essay should be a **maximum** of one page, must be typed, and turned in with your application.

Prompts (choose one):

1. Discuss each of the three areas of CHARACTER, LEADERSHIP, and SERVICE indicating how you feel you have met these qualifications. Give specific examples and do NOT just regurgitate your application.
2. What attribute do you most admire about your character and what attribute do you least admire about your character? Provide at least two anecdotes about yourself that best illustrate your CHARACTER considering the questions above. Personal stories and characteristics are acceptable to include.
3. What do you see as the function of an organization such as NHS? If selected to this group, how would you contribute to the continued growth and success of the NHS? What service activities would you like to see NHS pursue this year?

## VIII. Disciplinary Record

Have you ever been subjected to disciplinary action by EHS?  YES  NO

Have you ever been convicted of a violation of any state or federal law, other than a traffic violation?  YES  NO

If you answered "YES" to either of the above statements, explain fully in the space below.

---

---

---

---

## IX. Teacher Recommendations

You must provide **THREE** teacher recommendations – two of which must be a core teacher from your junior year, the third may be from any teacher you have had during your high school years. Any additional recommendations (above the three required) may also be submitted from a coach or employer. You must provide the teacher recommendation form and an envelope to each teacher, who will return the sealed envelope to you. You are responsible for obtaining recommendations forms and submitting them with your application. The envelope must have the teacher's signature across its seal. Be sure to be considerate and allow teachers adequate time to complete the recommendation form so that you will have them to submit with your application by the deadline.

## X. Application Checklist – Place all items in a sealed manila envelope with your name written on the outside of the envelope.

- \_\_\_\_\_ 1. Completed **application** (typed or legibly written in blue/black ink) stapled in page order
- \_\_\_\_\_ 2. Obtained all necessary **signatures** verifying participation, involvement, leadership, or service as indicated
- \_\_\_\_\_ 3. Typed **Personal Statement** (response to one of the prompts with a well-developed essay)
- \_\_\_\_\_ 4. Three **Faculty Recommendations** in sealed envelopes
  - Ask 3 teachers (at least two must be teachers of core classes during JUNIOR year) to complete recommendation forms that evaluate you in the areas of character, leadership, and service.
  - You must make copies of the form to distribute to your teachers. Additional recommendations (above the required 3) may also be submitted from a coach or employer.
  - Submit the form and an envelope to each teacher, who will return the sealed envelope to you. You are responsible for obtaining recommendation forms and submitting them with your application. The envelope **MUST** have the teacher's signature across its seal or will not be considered.
- \_\_\_\_\_ 5. 1 self-addressed stamped envelope (regular letter size only) – this will be used when a letter is sent stating whether or not you are accepted into NHS.

**All completed applications are due by 3:30PM on Thursday, September 6. Late applications will not be accepted.** Please double-check your application. If something is missing, hence incomplete, you will not be considered for acceptance into the NHS! If you have any questions, please see Margo Kemmerer (EE 209) prior to the deadline.

# National Honor Society Teacher Recommendation Form

**Student Name:** \_\_\_\_\_ **Teacher Name:** \_\_\_\_\_

Teachers: Thank you for filling out this recommendation to Etowah's chapter of National Honor Society for the above named student. As established by the national charter, in order to become a member a student must not only excel in scholarship, but also in leadership, character and service. We ask that you rank this student on these four areas using the standards below. Please check the box that is appropriate and provide any additional comments in the space following. This recommendation is confidential, so thank you in advance for your honesty and candidness. **Please return this completed form to the student in the envelope he/she provided for you. Be sure to sign over the seal of the envelope.**

**List the course(s) you have taught this student and circle the year you taught him/her:**

\_\_\_\_\_ (circle one)    9<sup>th</sup> grade            10<sup>th</sup> grade            11<sup>th</sup> grade  
 \_\_\_\_\_ (circle one)    9<sup>th</sup> grade            10<sup>th</sup> grade            11<sup>th</sup> grade  
 \_\_\_\_\_ (circle one)    9<sup>th</sup> grade            10<sup>th</sup> grade            11<sup>th</sup> grade

**What are the first three words that come to your mind to describe this student?**

\_\_\_\_\_

	Outstanding	Good	Fair	Poor	Unable to Judge
Creative, original thought					
Motivation					
Self-confidence					
Independence					
Initiative					
Reliability					
Disciplined work habits					
Academic integrity					
Personal integrity					
Leadership in the classroom					
Ability to work well with others					
Overall character of applicant					

**How strongly do you recommend this student for admission into the EHS chapter of NHS? (circle one)**

- Enthusiastically recommend*
- Recommend*
- Recommend with reservation (Please explain!)*
- Do NOT recommend (Please explain!)*

**Is there anything else you would like us to know about this student? If you marked "poor" in the chart above, please explain.**

\_\_\_\_\_  
 \_\_\_\_\_  
 \_\_\_\_\_

**Teacher's Signature:** \_\_\_\_\_ **Date:** \_\_\_\_\_

Thank you for your time. Please return this completed form to the student in a sealed envelope with your signature across the seal.

# National Honor Society Teacher Recommendation Form

**Student Name:** \_\_\_\_\_ **Teacher Name:** \_\_\_\_\_

Teachers: Thank you for filling out this recommendation to Etowah's chapter of National Honor Society for the above named student. As established by the national charter, in order to become a member a student must not only excel in scholarship, but also in leadership, character and service. We ask that you rank this student on these four areas using the standards below. Please check the box that is appropriate and provide any additional comments in the space following. This recommendation is confidential, so thank you in advance for your honesty and candidness. **Please return this completed form to the student in the envelope he/she provided for you. Be sure to sign over the seal of the envelope.**

**List the course(s) you have taught this student and circle the year you taught him/her:**

\_\_\_\_\_ (circle one)    9<sup>th</sup> grade            10<sup>th</sup> grade            11<sup>th</sup> grade  
 \_\_\_\_\_ (circle one)    9<sup>th</sup> grade            10<sup>th</sup> grade            11<sup>th</sup> grade  
 \_\_\_\_\_ (circle one)    9<sup>th</sup> grade            10<sup>th</sup> grade            11<sup>th</sup> grade

**What are the first three words that come to your mind to describe this student?**

\_\_\_\_\_

	Outstanding	Good	Fair	Poor	Unable to Judge
Creative, original thought					
Motivation					
Self-confidence					
Independence					
Initiative					
Reliability					
Disciplined work habits					
Academic integrity					
Personal integrity					
Leadership in the classroom					
Ability to work well with others					
Overall character of applicant					

**How strongly do you recommend this student for admission into the EHS chapter of NHS? (circle one)**

- Enthusiastically recommend*
- Recommend*
- Recommend with reservation (Please explain!)*
- Do NOT recommend (Please explain!)*

**Is there anything else you would like us to know about this student? If you marked "poor" in the chart above, please explain.**

\_\_\_\_\_  
 \_\_\_\_\_  
 \_\_\_\_\_

**Teacher's Signature:** \_\_\_\_\_ **Date:** \_\_\_\_\_

Thank you for your time. Please return this completed form to the student in a sealed envelope with your signature across the seal.

# National Honor Society Teacher Recommendation Form

**Student Name:** \_\_\_\_\_ **Teacher Name:** \_\_\_\_\_

Teachers: Thank you for filling out this recommendation to Etowah's chapter of National Honor Society for the above named student. As established by the national charter, in order to become a member a student must not only excel in scholarship, but also in leadership, character and service. We ask that you rank this student on these four areas using the standards below. Please check the box that is appropriate and provide any additional comments in the space following. This recommendation is confidential, so thank you in advance for your honesty and candidness. **Please return this completed form to the student in the envelope he/she provided for you. Be sure to sign over the seal of the envelope.**

**List the course(s) you have taught this student and circle the year you taught him/her:**

\_\_\_\_\_ (circle one)    9<sup>th</sup> grade            10<sup>th</sup> grade            11<sup>th</sup> grade  
 \_\_\_\_\_ (circle one)    9<sup>th</sup> grade            10<sup>th</sup> grade            11<sup>th</sup> grade  
 \_\_\_\_\_ (circle one)    9<sup>th</sup> grade            10<sup>th</sup> grade            11<sup>th</sup> grade

**What are the first three words that come to your mind to describe this student?**

\_\_\_\_\_

	Outstanding	Good	Fair	Poor	Unable to Judge
Creative, original thought					
Motivation					
Self-confidence					
Independence					
Initiative					
Reliability					
Disciplined work habits					
Academic integrity					
Personal integrity					
Leadership in the classroom					
Ability to work well with others					
Overall character of applicant					

**How strongly do you recommend this student for admission into the EHS chapter of NHS? (circle one)**

- Enthusiastically recommend*
- Recommend*
- Recommend with reservation (Please explain!)*
- Do NOT recommend (Please explain!)*

**Is there anything else you would like us to know about this student? If you marked "poor" in the chart above, please explain.**

\_\_\_\_\_  
 \_\_\_\_\_  
 \_\_\_\_\_

**Teacher's Signature:** \_\_\_\_\_ **Date:** \_\_\_\_\_

Thank you for your time. Please return this completed form to the student in a sealed envelope with your signature across the seal.

## HOW TO Scan a Document

1. Log-in to the printer using your school computer log-in and password.

2. When you log-in, a pop-up will say **CANNOT FIND THE HOME DIRECTORY**, press **O.K.**

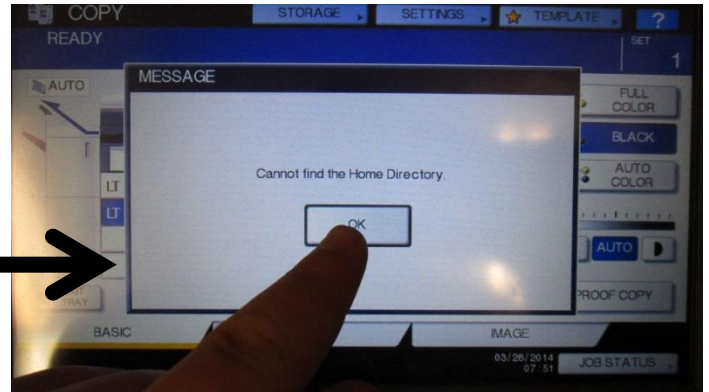

3. Place your documents face up in the document feeder on the top of the copier

4. Press the SCAN button on the left side of the key pad



5. Click Email

6. Click To

7. Click Input

8. Type Email address: [margo.kemmerer@cherokee.k12.ga.us](mailto:margo.kemmerer@cherokee.k12.ga.us)

9. Click OK

9. Click Start

10. Click Job Finish – you should see a message that sending email (it may also say power failure – please disregard this message)

11. Don't forget to take your documents with you 😊